

inspired LED *Impression Series: Retrofit Installation Guide*

Instructions: Please note; instructions are intended to guide the installation of Impression Series channels, lights, and lenses. It is recommended that all drywall and electrical work be completed by licensed and experienced professionals.

Materials:

- Retrofit Aluminum Channel
- 12V or 24V Mega Bright Flexible LED strips in desired color (one per channel)
- Retrofit Lens
- End caps (two per channel)
- Table saw with blade for plastic and aluminum
- 5/8" drywall sheetrock (installed, textured, painted)
- Measuring tape
- Level tool
- Construction adhesive
- Pencil
- Scissors
- Oscillating saw or jab saw
- 16-22AWG in-wall rated cable
- Class 2 12V or 24V DC power source
- Wire nuts

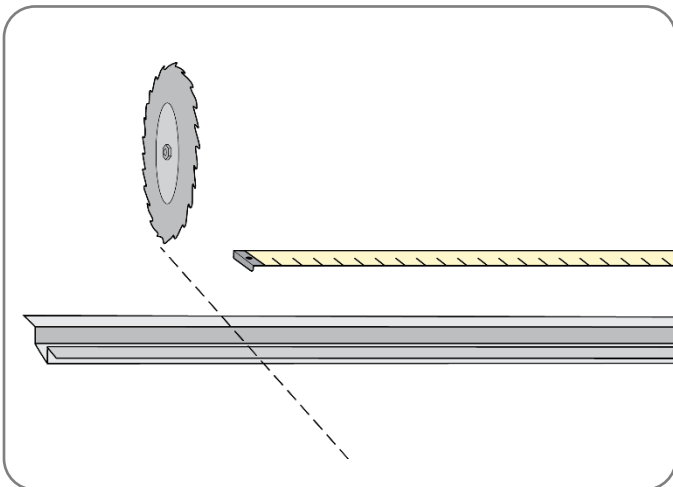

Step 1: Measure and mark desired length of aluminum channel and lens. Cut using table saw and appropriate blade designated for plastic or aluminum (depending on material).

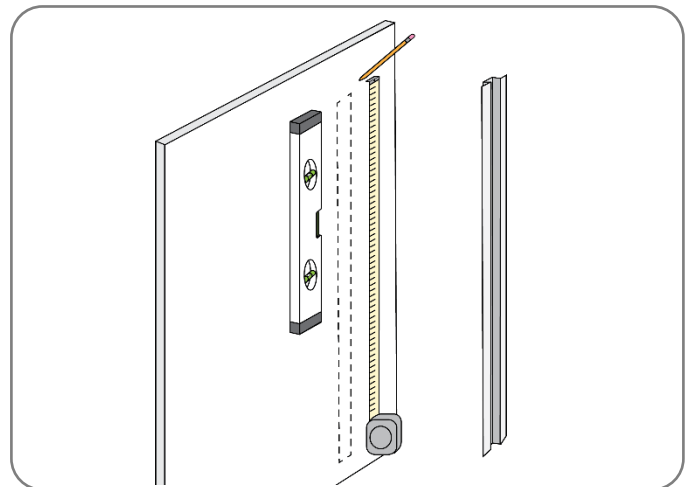

Step 2: Using your level and/or T-square as a guide, measure and mark the length and width of the wall reveal in desired location on drywall. Final cut-out should measure 3/4" wide.

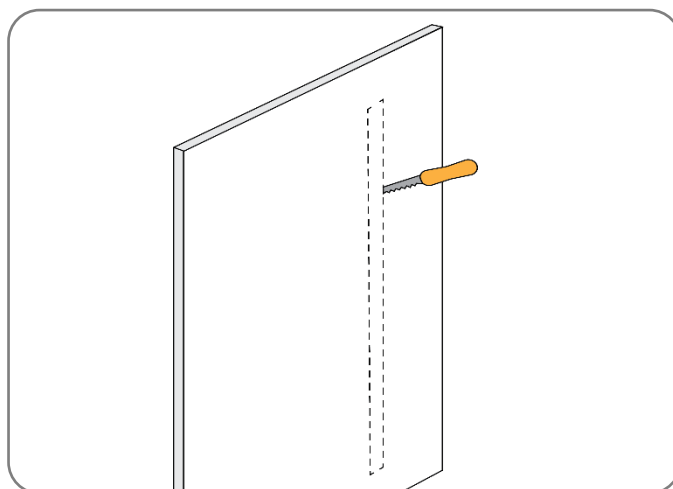

Step 3: Use oscillating saw or jab saw to cut away the marked drywall. Clear away as much debris as possible from inside the wall.

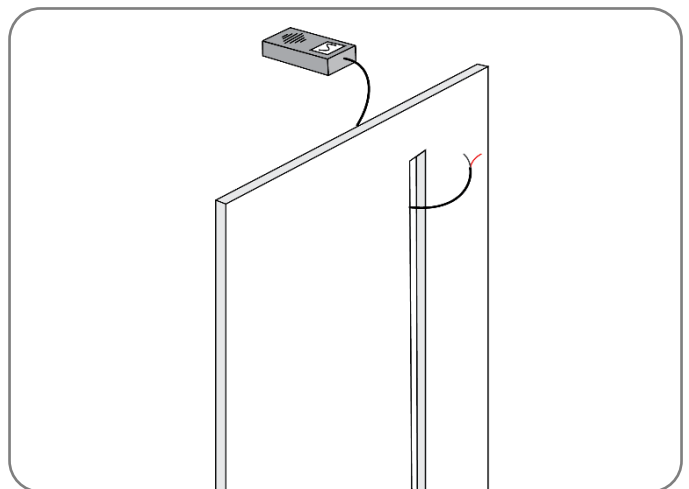

Step 4: Use in-wall rated **solid gauge** cable to create wire drops from Class 2 12V or 24V DC power supply to desired locations, leaving at least a 12" lead. Test power supply and wire drops to ensure functionality.

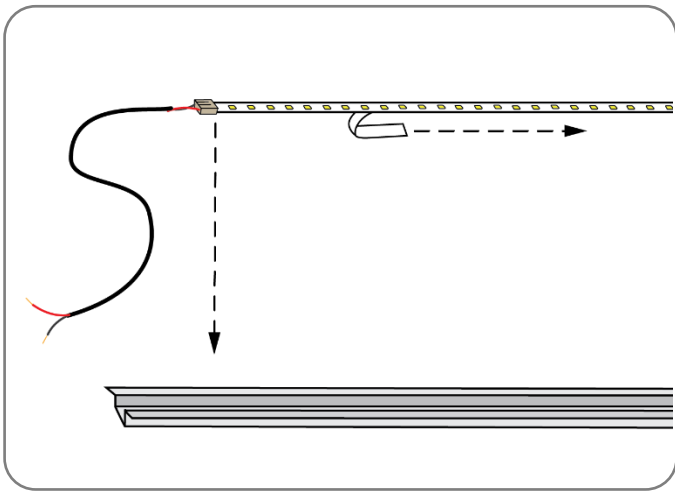

Step 5: Peel back adhesive from LED flex strip and insert into aluminum channel, ensuring some extra space is left near any flying leads (about 1”).

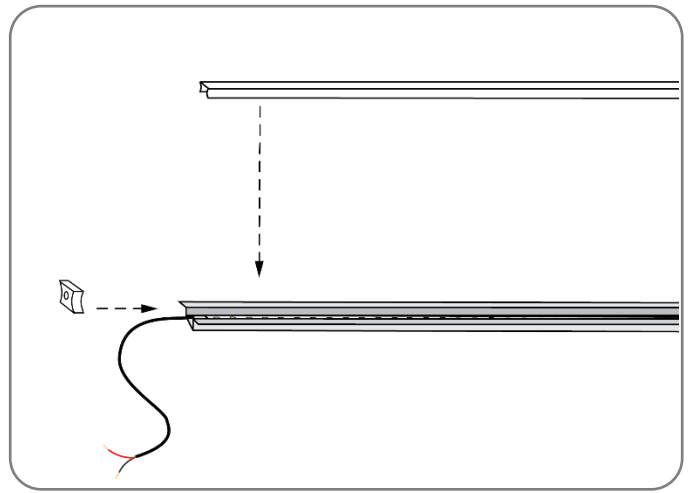

Step 6: Snap retrofit lens into place over LEDs inside of aluminum and connect end caps on either side. Be sure to feed any output leads through a wire hole.

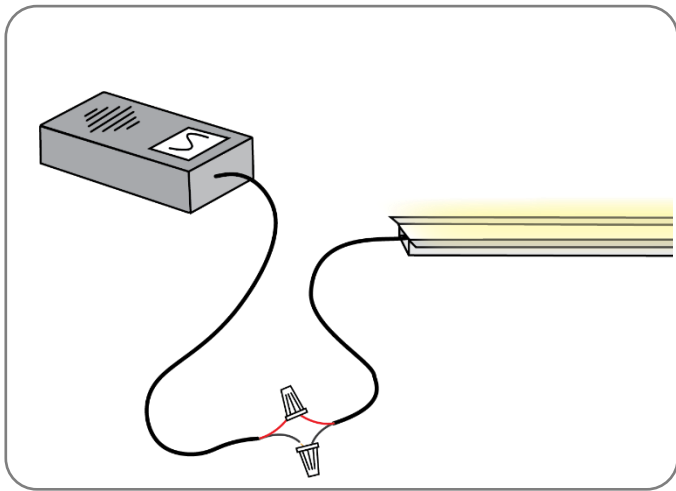

Step 7: Connect completed panel to 12V or 24V power source (depending on LEDs selected) and test for functionality before completing installation.

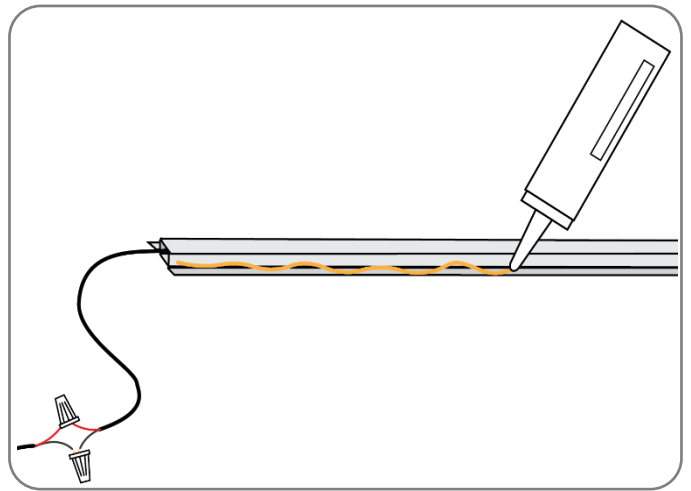

Step 8: Once connections and power have been confirmed, apply construction adhesive around the back side of aluminum and end caps.

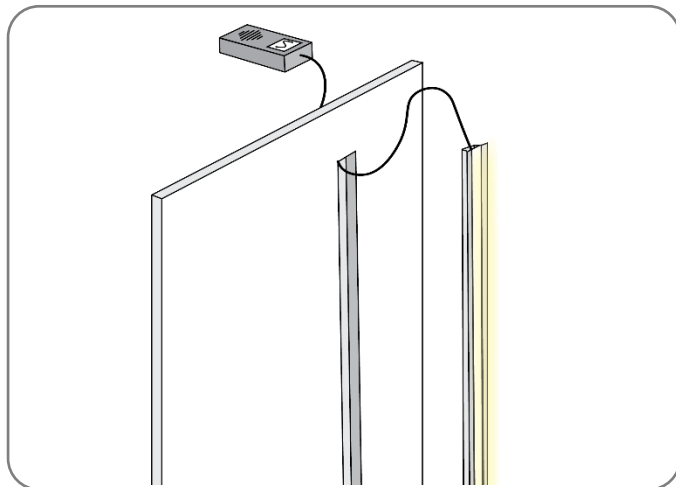

Step 9: Gently insert the retrofit panel into pre-cut hole in drywall, ensuring that wires are tucked away inside the wall. Mount flush, wiping away any excess glue.

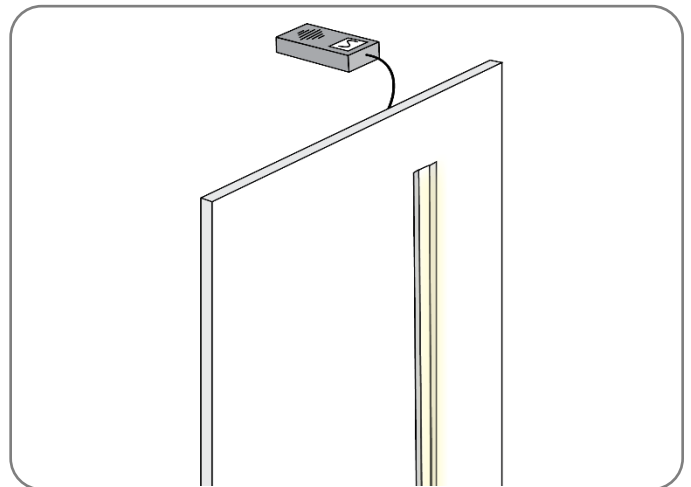

Completed install. For assistance during installation, including troubleshooting issues, contact us using the information below.



distributors@inspiredled.com



(480) 941-4286