

Dimmable LED Magnetic Transformers from Inspired LED

Transformers are available in 40, 60 and 100 Watt Versions

Transformer

The actual transformer is encapsulated in the enclosure. Input leads are 20 AWG output leads are 16 AWG. Lead insulation is 105°C. The transformer uses a class B 130°C insulation system.

Enclosure

Enclosure temperature does not exceed 70°C @ 40°C ambient. Wiring compartment has 2 knockouts sized For 3/4 inch screw cable connectors. The removable cover for the wiring compartment is secured in place by screw. The enclosure is black powder coated.

General

The transformer has a manual reset thermal circuit breaker on the secondary side. The transformer can be controlled with a low-voltage dimmer. The transformer is ETL listed.

Note; Dimmable Transformers require a Magnetic Low Voltage Wall Dimmer for proper operation. Here is the list of approved Dimmers Inspired LED recommends DVLV-600 for Diva paddle style and AYLV-600 standard toggle style switches.

CAUTION Triac or LED Dimmers will damage Transformer

Lutron Ariadni Dimmer		
AYLV-603P	AYLV-603P-CSA	AYLV-603P-S
AYLV-600P	AYLV-600P-CSA	AYLV-600P-S
Lutron Vareo Dimmer		
V-1000	V-600	V-1000-S
V-600-S	VETN-1000	VETS-1000
VETS-1000-CSA	VETN-1000-S	VETS-1000-S
VETS-R	VETS-R-S	VETS-1000-SL
VETS-1000-SL-S	VETS-A-SL	VETS-A-SL-S
Lutron Nova Dimmer		
NTLV-1000	NTLV-1500	NTLV-600
NTLV-1500-S	NTLV-600-S	NTLV-1000-S
NTLV-1503P	NTLV-2003P	NTLV-1003P
NTLV-603P	NTLV-1503P-CSA	NTLV-1003P-CSA
NTLV-603P-CSA	NTLV-1503P-S	NTLV-2003P-S
NTLV-1003P-S	NTLV-603P-S	NT-3PS
NT-3PS-CSA	NT-3PS-S	NT-4PS
NT-4PS-CSA	NT-4PS-S	NT-1PS
NT-1PS-CSA	NT-1PS-S	
Lutron Ceana Dimmer		
CNLV-603P	CNLV-600P	
Lutron Diva Dimmer		
DVLV-103P	DVLV-603P	DVSLV-103P
DVSLV-603P	DVLV-103P-CSA	DVLV-603P-CSA
DVLV-103P-S	DVLV-603P-S	DVLV-103PH-S
DVLV-603PH-S	DVSLV-103P-L	DVSLV-603P-L
DVLV-600P	DVLV-10P	DVSLV-10P
DVSLV-600P	DVLV-10P-CSA	DVLV-10P-S
DVLV-10PH-S	DVSLV-10P-L	SC-3PS
SC-3PS	SC-4PS	SC-4PS
SC-1PS	SC-1PS	SC-3PSNL
SC-4PSNL	SC-1PSNL	
Lutron Glyder Dimmer		
GLV-600	GLV-600-CSA	
Lutron Lyneo Dimmer		
LXLV-103PL	LXLV-603PL	LXLV-10PL
LXLV-600PL		
Lutron Nova T Dimmer		
NTLV-1500	NTLV-1000	NTLV-1000-277
NTLV-600	NTLV-600-277	
Lutron Skylark Dimmer		
SLV-603P	SLV-603P-CSA	SLV-603PH-CSA
SLV-600P	SLV-600P-CSA	SLV-600PH-CSA

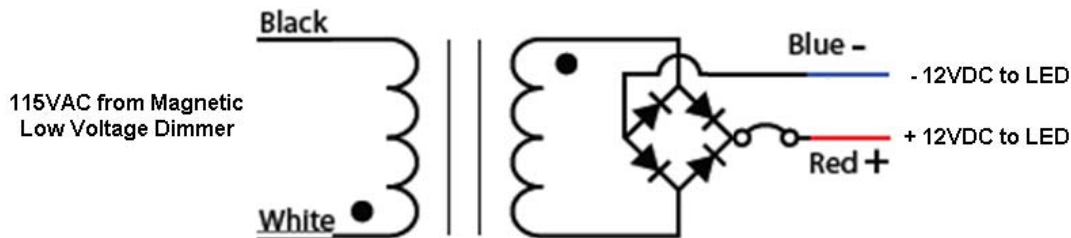

12VDC 40Watt
Item 4789

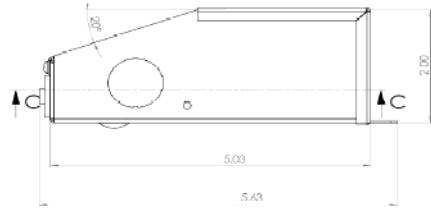
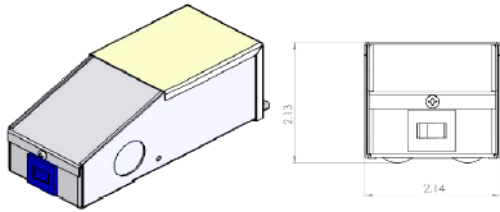

Dimensions in inches:		
L	W	D
5.03	2.14"	2"

Max Load	40W
Input Voltage	120V 60Hz
Output Voltage Full Load	11.4VDC
Input Current Full Load	360mA
Open Circuit Volts	12.5VDC
Output Current Full Load	3.19A
Efficiency	87.50%
Coil Former	Double Section Bobbin
Thermal Class	B 130C
Leads Primary	PVC 600V 20#
Leads Secondary	PVC 300V 16#

12VDC 60Watt
Item 4790

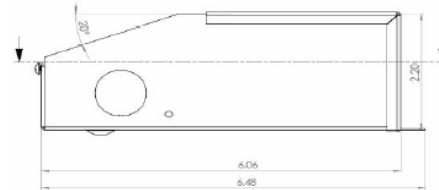
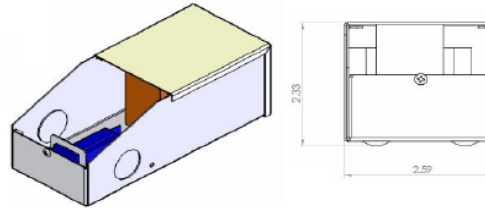

Dimensions in inches:		
L	W	D
6.06"	2.59"	2.2"

Max Load	60W
Input Voltage	120V 60Hz
Output Voltage Full Load	11.5VDC
Input Current Full Load	540mA
Open Circuit Volts	12.5VDC
Output Current Full Load	4.8A
Efficiency	89.20%
Coil Former	Double Section Bobbin
Thermal Class	B 130C
Leads Primary	PVC 600V 20#
Leads Secondary	PVC 300V 14#

12VDC 100Watt
Item 4791

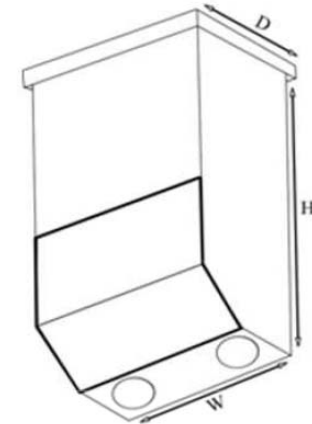

Dimensions in inches:		
L	W	D
7.56	3.06	2.94

Max Load	100W
Input Voltage	120V 60Hz
Output Voltage Full Load	11.57VDC
Input Current Full Load	898mA
Open Circuit Volts	12.5VDC
Output Current Full Load	8.05A
Efficiency	87.20%
Coil Former	Double Section Bobbin
Thermal Class	B 130C
Leads Primary	PVC 600V 18#
Leads Secondary	PVC 300V 12#

Dimmable Transformer System from Inspired LED

Custom Length Designer Series

Ultra Bright Flex, Under Cabinet Lighting

Super Bright Flex, Under cabinet lighting

Bright Flex, Accent lights for Coves, Kicks and Glass Doors

21 LED Light Panel

Interconnect Cables

For Surface Wiring tie Inspired LED Interconnect Cables direct to the Dimmable Transformer with wire nuts

Transformers are available in 40, 60 & 100 Watt Versions

Magnetic Low Voltage Dimmer
Lutron DVLV-600

Dimmable Transformer is hard wired to Magnetic Dimmer Switch.

For in wall wiring applications use DC Feeder Wire 14-2 Class 3 CMR Rated In Wall

Custom Lengths Available

Surface Mount Transformer in location that makes the shortest possible DC wire runs. Keep DC wires separated from AC Wiring. Never mount in the wall.

Strip and Wire nut to (-) 12VDC

White Lettering Denotes +12 VDC

Strip and Wire nut to (+) 12VDC

Tie (+) Wire to 12VDC Red Wire of Transformer.

To extend the IN Wall wire to a LED Panel or Flex Strip, create a pig tail from any of our Interconnect Cables. Strip and Wire Nut. Custom Plug and Play In Wall Cables Available

For IN WALL Wiring Tie (+) Wire to 12VDC Red Wire of Transformer.

